

LIGHTING SOLUTION

FOR RETAIL DISPLAY



Gruppo Comestero Sistemi



COMESTERO PRODUCTION

ABOUT US

Gruppo Comestero Sistemi is an international company that, since almost 50 years, is involved in co-engineering, production and sales of the best electromechanical components. Our aim is to develop innovative technical solutions.

Thanks to our know-how CS is able to be a partner for all companies that are looking for high added valued solutions to succeed and strengthen their presence in their own market.



CS Production is a branch of Gruppo Comestero Sistemi dedicated to the design and production of new components. Here below you can find some solutions:

- Led strip
- Anti-condensation heaters
- Combined connectors
- IDF 320 Fixing system
- LS Rotary switch
- FANLAB Axial Fans
- Piezo Actuators
- Piezoelectric Grippers

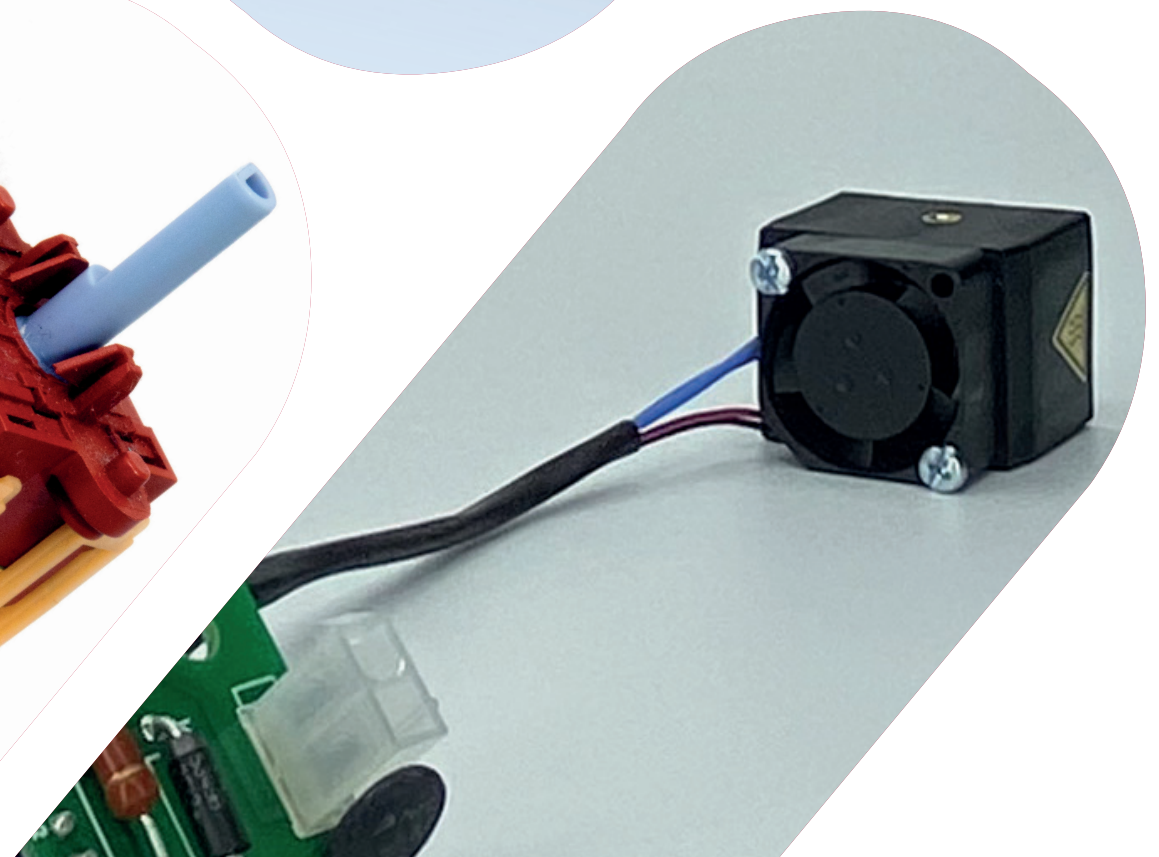
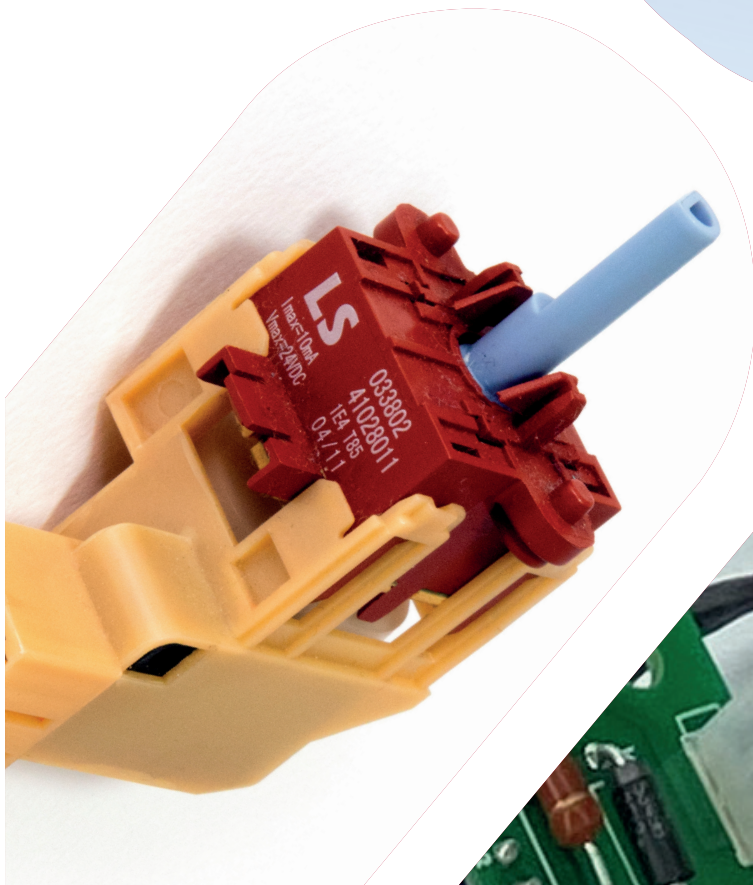

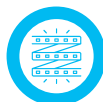

Serie A

LIGHTING SOLUTION



24V
DC

120°

IP65

22.5W/m

Product Features

- CRI 80Ra
- Highest quality components 2835 Leds
- 120° beam angle
- CCT white CCT available from 2800K 3000 ÷ 6500, PINK, RGB, Custom.
- 24V DC input voltage
- Up to 1200 lm/m
- Ambient Temperature: -20°C to 45°C
- Max Power consumption 22.5W/m
- IP Rating: IP65
- Lifetime 50.000h
- Energy labelling available (EPREL)

Customization

- Custom CCT to obtain your cromatic coordinates
- Custom length on request
- CRI 90Ra on request
- Input voltage on request

Material:

Cover in polycarbonate clear or opal
Side closure cap in PA 6
Profile in aluminium

Standard:

EN 62031-1, EN 62471-1, EN 61547-1, EN55015-1,
EN 60598-1, EN 60335-2-24, EN 60335-2-89



Dimensions

Dimension in mm

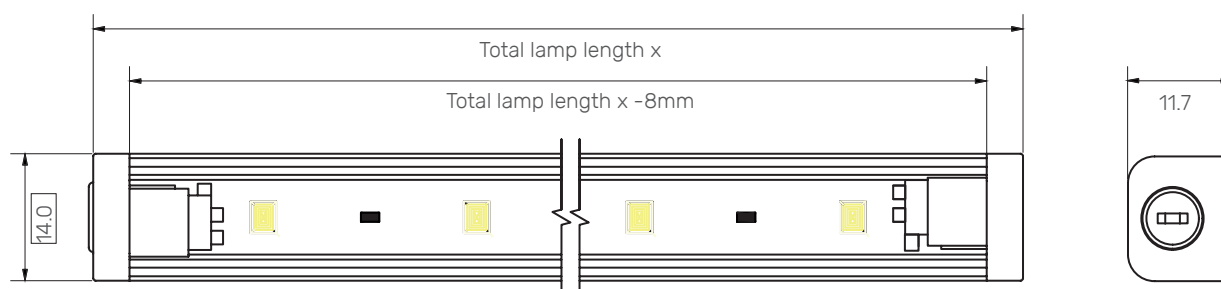

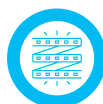

Specifications

COMBINATION CODE			(1)	(2)	(3)	VALUE					
Model	Length	Led Type	Voltage (V)	CCT* (K)	Connection*		Covering Finishing*	Lumen (lm)	Power (W)	n°LED	Length "x" (mm)
					R	L					
ELED-CSA	060	2835	24	3000 ÷ 6500 PINK RGB	A	A	0	432	4,5	36	608
					B	B	1	378			
ELED-CSA	090	2835	24	3000 ÷ 6500 PINK RGB	A	A	0	648	6,75	54	908
					B	B	1	567			
ELED-CSA	120	2835	24	3000 ÷ 6500 PINK RGB	A	A	0	864	9	72	1208
					B	B	1	756			
ELED-CSA	150	2835	24	3000 ÷ 6500 PINK RGB	A	A	0	1080	11,5	90	1508
					B	B	1	945			
High Performance Model											
ELED-CHA	060	2835	24	3000 ÷ 6500 PINK RGB	A	A	0	720	9	72	608
					B	B	1	630			
ELED-CHA	090	2835	24	3000 ÷ 6500 PINK RGB	A	A	0	1080	13,5	108	908
					B	B	1	945			
ELED-CHA	120	2835	24	3000 ÷ 6500 PINK RGB	A	A	0	1440	18	144	1208
					B	B	1	1250			
ELED-CHA	150	2835	24	3000 ÷ 6500 PINK RGB	A	A	0	1800	22,5	180	1508
					B	B	1	1575			

* choose an option from below

Color Temperature Options (1)



Connection Options (2)

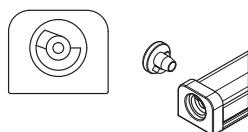

A Connection 3,5x1,35 female plug

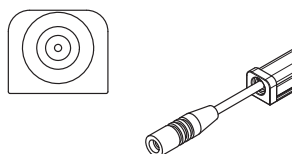

B Wire and 3,5x1,35 female plug Length 70mm

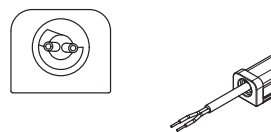

C Connection with wire Length 70mm

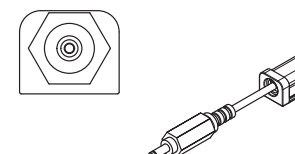

D Wire and 3,5x1,35 male plug Length 70mm



Cover Finishing (3)

0 Clear PC Cover

1 Opal PC Cover

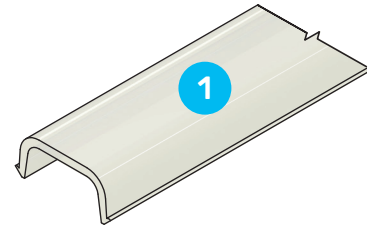
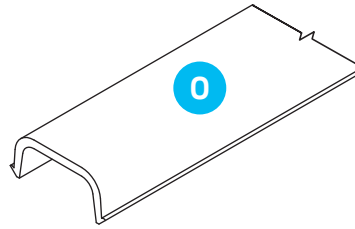

Accessories

Mounting Clip

Model	Type
ELED-CSA-CLIP-0	0
ELED-CSA-CLIP-M	M

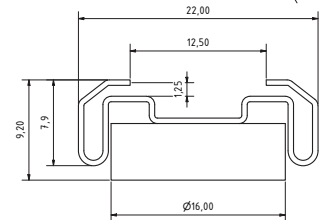
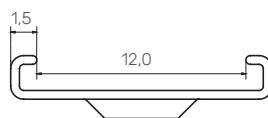
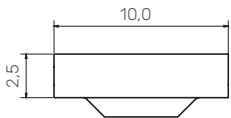
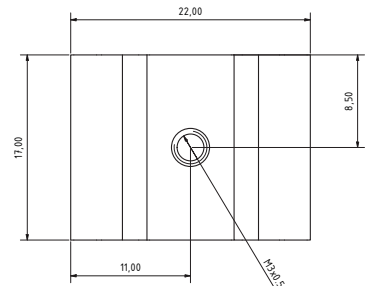
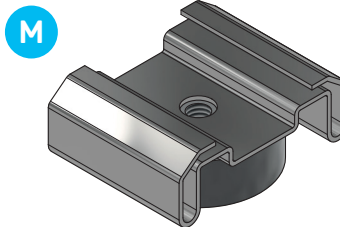
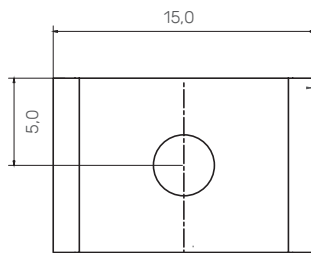
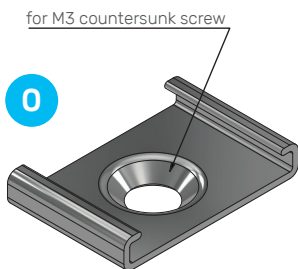

Wire Options

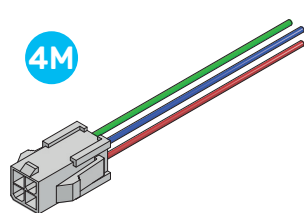
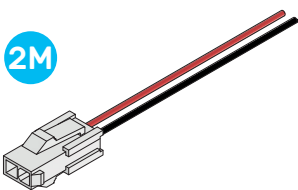

Model	Type	Length "c" (mm)
ELED-CAB-xxx-2M	2M	on request
ELED-CAB-xxx-4M	4M	on request
ELED-CAB-150-1C	1C	1500
ELED-CAB-050-2C	2C	500
ELED-CAB-050-3C	3C	500

*custom length on request

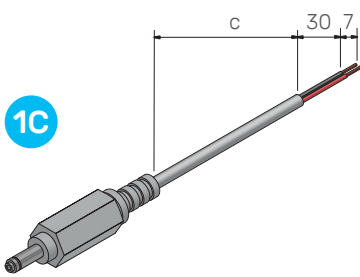

Wire AWG 24

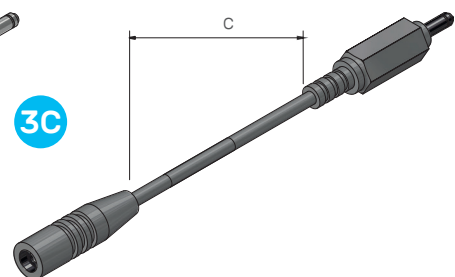
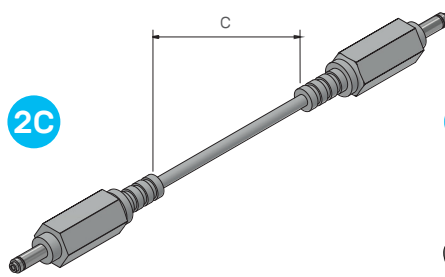

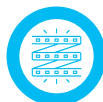

Serie B

LIGHTING SOLUTION

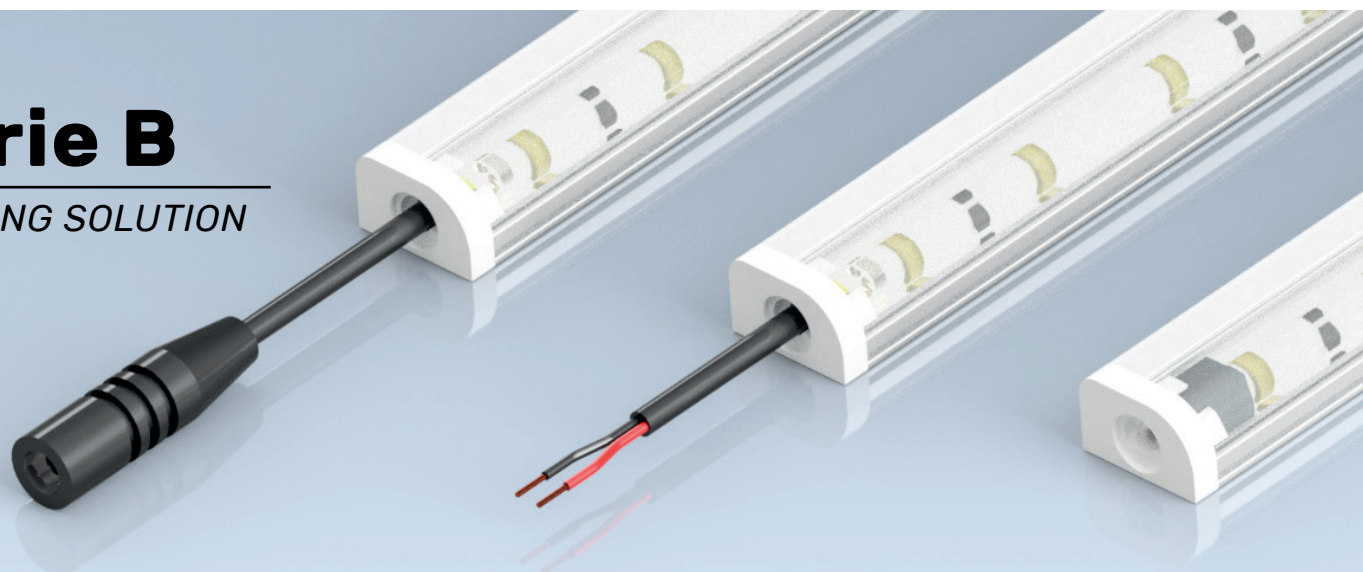

24V
DC

70°

IP65

22.5W/m

Product Features

- CRI 80Ra
- Highest quality components 2835 Leds
- 70° beam angle
- CCT white CCT available from 2800K 3000 ÷ 6500, PINK, RGB, Custom.
- 24V DC input voltage
- Up to 1200 lm/m
- Ambient Temperature: -20°C to 45°C
- Max Power consumption 22.5W/m
- IP Rating: IP65
- Lifetime 50.000h
- Energy labelling available (EPREL)

Customization

- Custom CCT to obtain your cromatic coordinates
- Custom length on request
- CRI 90Ra on request
- Input voltage on request

Material:

Cover in polycarbonate clear or opal
Side closure cap in PA 6
Profile in aluminium

Standard:

EN 62031-1, EN 62471-1, EN 61547-1, EN55015-1,
EN 60598-1, EN 60335-2-24, EN 60335-2-89

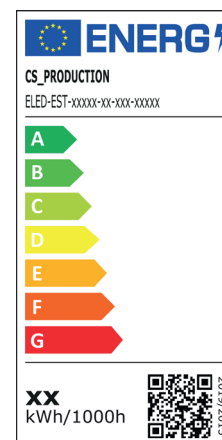

Dimensions

Dimension in mm

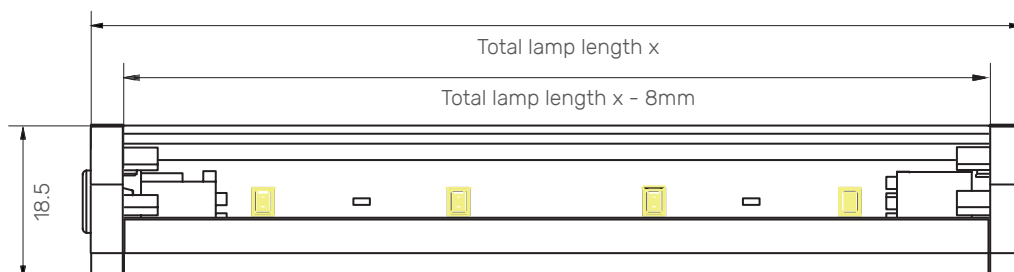



Specifications

COMBINATION CODE			(1)	(2)	(3)	VALUE					
Model	Length	Led Type	Voltage (V)	CCT* (K)	Connection*		Covering Finishing*	Lumen (lm)	Power (W)	n°LED	Length "x" (mm)
ELED-CSB	060	2835	24	3000 ÷ 6500 PINK RGB	A	A	0	432	4,5	36	608
					B	B					
ELED-CSB	090	2835	24	3000 ÷ 6500 PINK RGB	C	C	0	648	6,75	54	908
					D	D					
ELED-CSB	120	2835	24	3000 ÷ 6500 PINK RGB	A	A	0	864	9	72	1208
					B	B					
ELED-CSB	150	2835	24	3000 ÷ 6500 PINK RGB	C	C	0	1080	11,5	90	1508
					D	D					
High Performance Model											
ELED-CHB	060	2835	24	3000 ÷ 6500 PINK RGB	A	A	0	720	9	72	608
					B	B					
ELED-CHB	090	2835	24	3000 ÷ 6500 PINK RGB	C	C	0	1080	13,5	108	908
					D	D					
ELED-CHB	120	2835	24	3000 ÷ 6500 PINK RGB	A	A	0	1440	18	144	1208
					B	B					
ELED-CHB	150	2835	24	3000 ÷ 6500 PINK RGB	C	C	0	1800	22,5	180	1508
					D	D					

* choose an option from below

Color Temperature Options (1)



Connection Options (2)

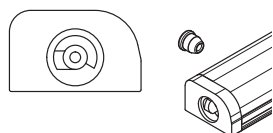

A Connection 3,5x1,35 female plug

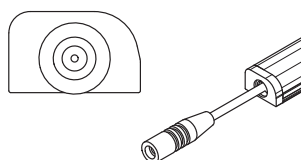

B Wire and 3,5x1,35 female plug Length 70mm

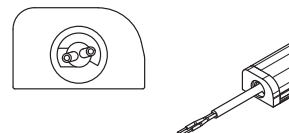

C Connection with wire Length 70mm

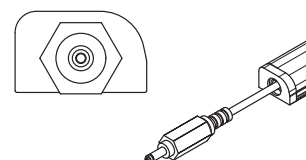

D Wire and 3,5x1,35 male plug Length 70mm

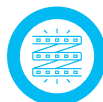

Cover Finishing (3)

0 Clear PC Cover

1 Opal PC Cover

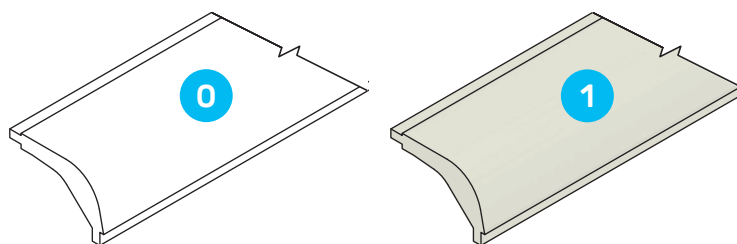

Accessories

Mounting Clip

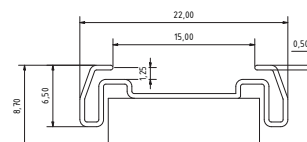
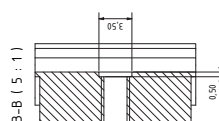
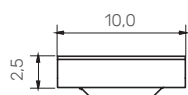
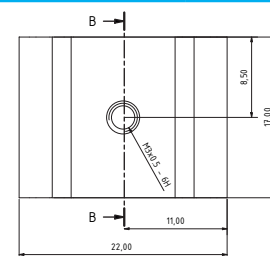
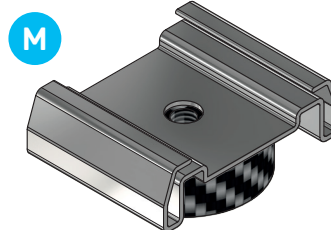
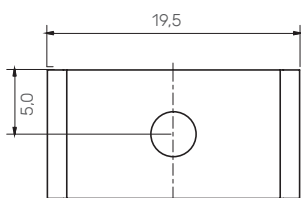

Model	Type
ELED-CSB-CLIP-0	0
ELED-CSB-CLIP-M	M

Wire Options

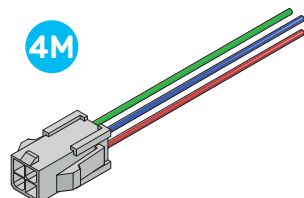
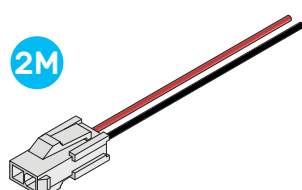

Model	Type	Length "c" (mm)
ELED-CAB-xxx-2M	2M	on request
ELED-CAB-xxx-4M	4M	on request
ELED-CAB-150-1C	1C	1500
ELED-CAB-050-2C	2C	500
ELED-CAB-050-3C	3C	500

*custom length on request

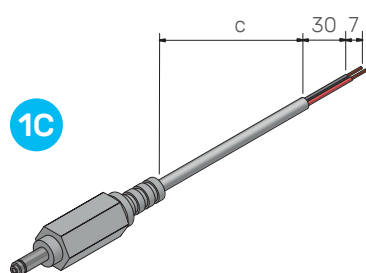

Wire AWG 24

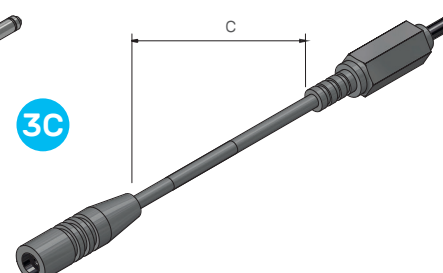
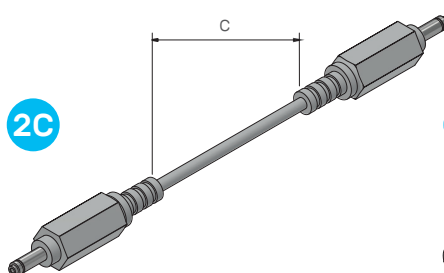

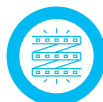

Serie C

LIGHTING SOLUTION

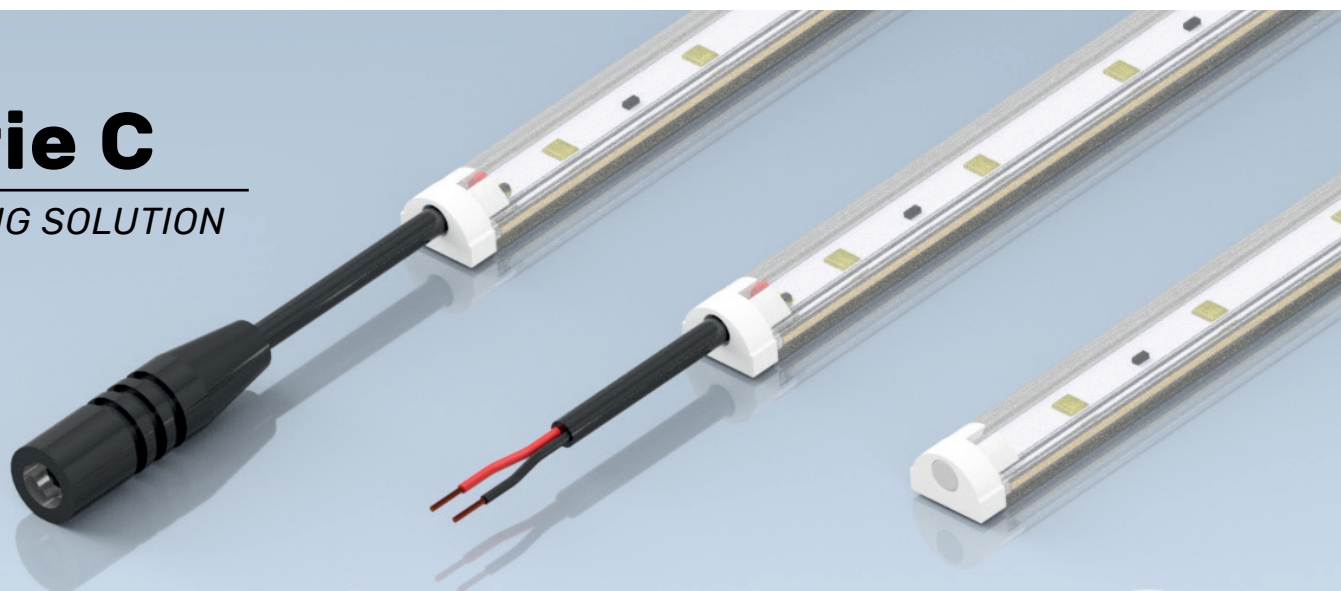

24V
DC

120°

IP65

22.5W/m

Product Features

- CRI 80Ra
- Highest quality components 2835 Leds
- 120° beam angle
- CCT white CCT available from 2800K 3000 ÷ 6500, PINK, RGB, Custom.
- 24V DC input voltage
- Up to 1200 lm/m
- Ambient Temperature: -20°C to 45°C
- Max Power consumption 22.5W/m
- IP Rating: IP65
- Lifetime 50.000h
- Energy labelling available (EPREL)

Customization

- Custom CCT to obtain your cromatic coordinates
- Custom length on request
- CRI 90Ra on request
- Input voltage on request

Material:

Cover in polycarbonate clear or opal
Side closure cap in PA 6
Profile in aluminium

Standard:

EN 62031-1, EN 62471-1, EN 61547-1, EN55015-1,
EN 60598-1, EN 60335-2-24, EN 60335-2-89

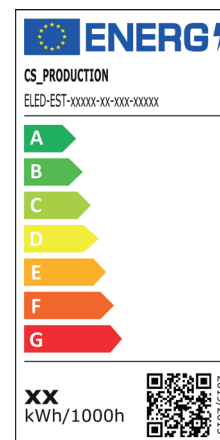

Dimensions

Dimension in mm

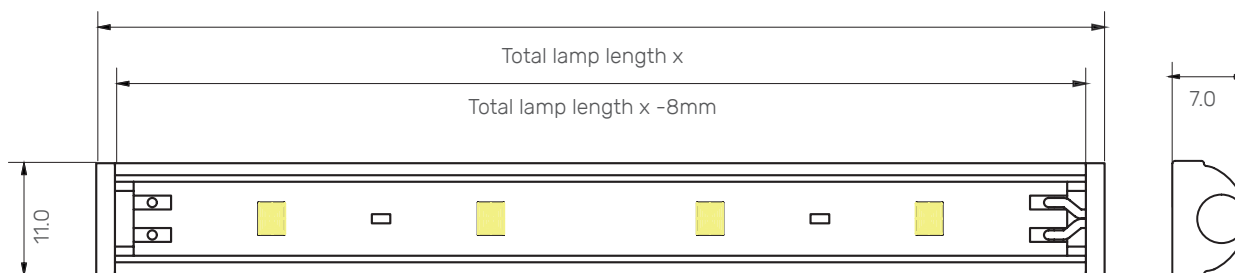

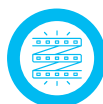

Specifications

COMBINATION CODE			(1)	(2)	(3)	VALUE					
Model	Length	Led Type	Voltage (V)	CCT* (K)	Connection*		Covering Finishing*	Lumen (lm)	Power (W)	n°LED	Length "x" (mm)
ELED-CSC	060	2835	24	3000 ÷ 6500 PINK RGB	B C D	B C D Z	0	432	4,5	36	608
							1	378			
ELED-CSC	090	2835	24	3000 ÷ 6500 PINK RGB	B C D	B C D Z	0	648	6,75	54	908
							1	567			
ELED-CSC	120	2835	24	3000 ÷ 6500 PINK RGB	B C D	B C D Z	0	864	9	72	1208
							1	756			
ELED-CSC	150	2835	24	3000 ÷ 6500 PINK RGB	B C D	B C D Z	0	1080	11,5	90	1508
							1	945			
High Performance Model											
ELED-CHC	060	2835	24	3000 ÷ 6500 PINK RGB	B C D	B C D Z	0	720	9	72	608
							1	630			
ELED-CHC	090	2835	24	3000 ÷ 6500 PINK RGB	B C D	B C D Z	0	1080	13,5	108	908
							1	945			
ELED-CHC	120	2835	24	3000 ÷ 6500 PINK RGB	B C D	B C D Z	0	1440	18	144	1208
							1	1250			
ELED-CHC	150	2835	24	3000 ÷ 6500 PINK RGB	B C D	B C D Z	0	1800	22,5	180	1508
							1	1575			

* choose an option from below

Color Temperature Options (1)

3000

4000

6500

PINK

RGB

Custom

Connection Options (2)

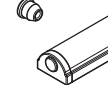
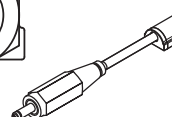
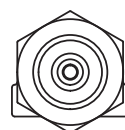
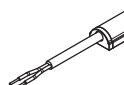
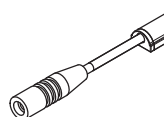
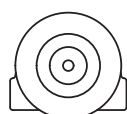
**B** Wire and 3,5x1,35 female plug
Length 70mm**C** Connection with wire
Length 70mm**D** Wire and 3,5x1,35 male plug
Length 70mm**Z** No connection



Cover Finishing (3)

0 Clear PC Cover

1 Opal PC Cover

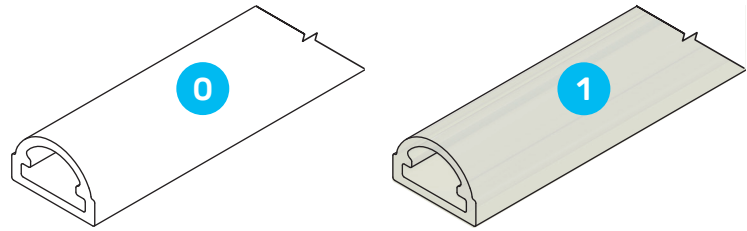

Accessories

Mounting Clip

Model	Type
ELED-CSC-CLIP-0	0

0

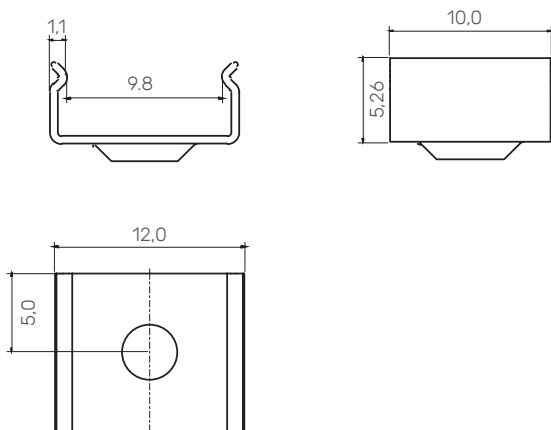

for M3 countersunk screw

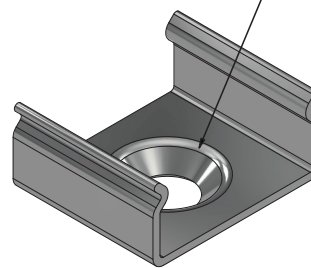

Wire Options

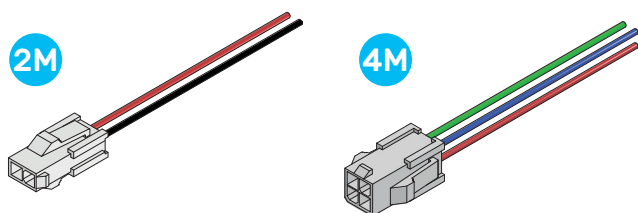

Model	Type	Length "c" (mm)
ELED-CAB-xxx-2M	2M	on request
ELED-CAB-xxx-4M	4M	on request
ELED-CAB-150-1C	1C	1500
ELED-CAB-050-2C	2C	500
ELED-CAB-050-3C	3C	500

*custom length on request

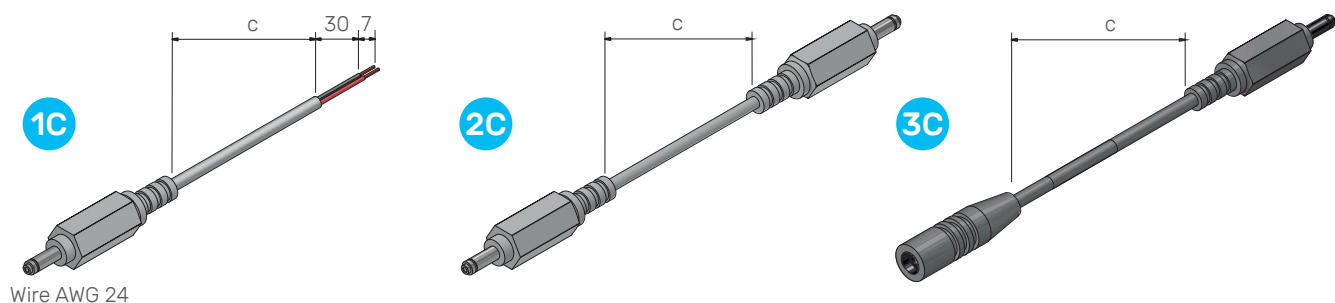

Wire AWG 24

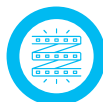

Serie D

LIGHTING SOLUTION

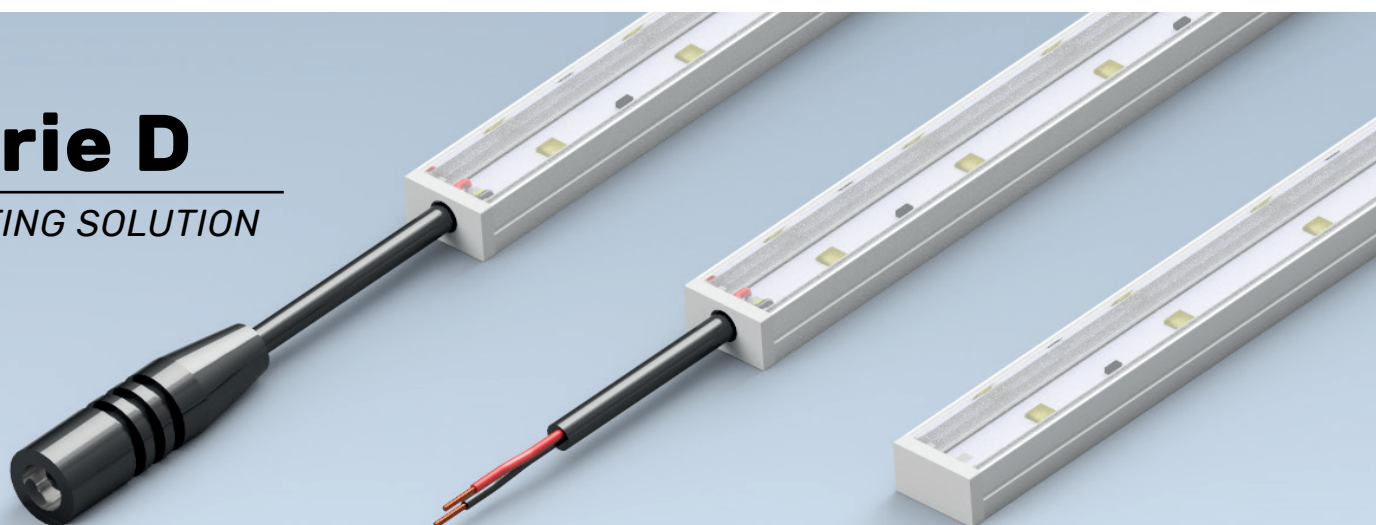

24V
DC

120°

IP55

22.5W/m

Product Features

- CRI 80Ra
- Highest quality components 2835 Leds
- 120° beam angle
- CCT white CCT available from 2800K 3000 ÷ 6500, PINK, RGB, Custom.
- 24V DC input voltage
- Up to 1200 lm/m
- Ambient Temperature: -20°C to 45°C
- Max Power consumption 22.5W/m
- IP Rating: IP55
- Lifetime 50.000h
- Energy labelling available (EPREL)

Customization

- Custom CCT to obtain your cromatic coordinates
- Custom length on request
- CRI 90Ra on request
- Input voltage on request

Material:

Cover in polycarbonate clear or opal
Side closure cap in PA 6
Profile in aluminium

Standard:

EN 62031-1, EN 62471-1, EN 61547-1, EN55015-1,
EN 60598-1, EN 60335-2-24, EN 60335-2-89



Dimensions

Dimension in mm

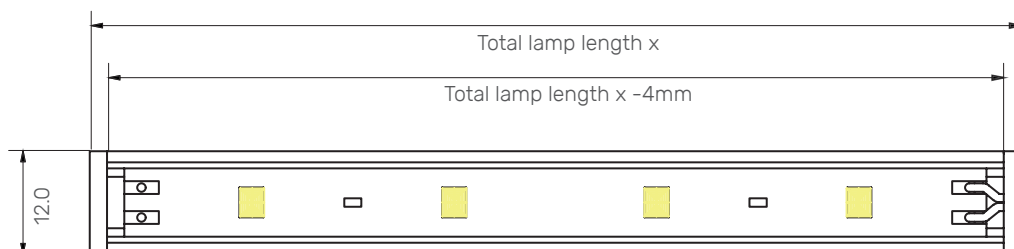

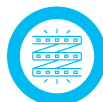

Specifications

COMBINATION CODE			(1)	(2)	(3)	VALUE					
Model	Length	Led Type	Voltage (V)	CCT* (K)	Connection*		Covering Finishing*	Lumen (lm)	Power (W)	n°LED	Length "x" (mm)
					R	L					
ELED-CSD	060	2835	24	3000 ÷ 6500 PINK RGB	B C D	B C D Z	0	432	4,5	36	604
							1	378			
ELED-CSD	090	2835	24	3000 ÷ 6500 PINK RGB	B C D	B C D Z	0	648	6,75	54	904
							1	567			
ELED-CSD	120	2835	24	3000 ÷ 6500 PINK RGB	B C D	B C D Z	0	864	9	72	1204
							1	756			
ELED-CSD	150	2835	24	3000 ÷ 6500 PINK RGB	B C D	B C D Z	0	1080	11,5	90	1504
							1	945			
High Performance Model											
ELED-CHD	060	2835	24	3000 ÷ 6500 PINK RGB	B C D	B C D Z	0	720	9	72	604
							1	630			
ELED-CHD	090	2835	24	3000 ÷ 6500 PINK RGB	B C D	B C D Z	0	1080	13,5	108	904
							1	945			
ELED-CHD	120	2835	24	3000 ÷ 6500 PINK RGB	B C D	B C D Z	0	1440	18	144	1204
							1	1250			
ELED-CHD	150	2835	24	3000 ÷ 6500 PINK RGB	B C D	B C D Z	0	1800	22,5	180	1504
							1	1575			

* choose an option from below

Color Temperature Options (1)



Connection Options (2)

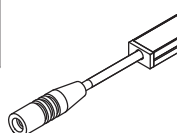
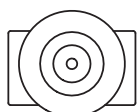

B Wire and 3,5x1,35 female plug
Length 70mm

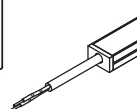
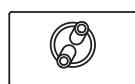

C Connection with wire
Length 70mm

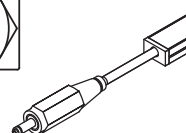

D Wire and 3,5x1,35 male plug
Length 70mm



Z No connection



Cover Finishing (3)

0 Clear PC Cover

1 Opal PC Cover

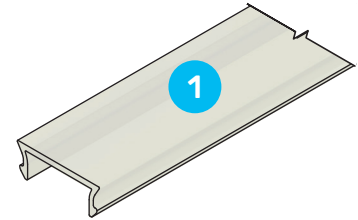
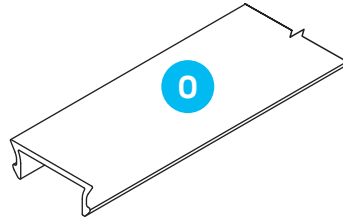

Accessories

Mounting Clip

Model	Type
ELED-CSD-CLIP-0	0

0

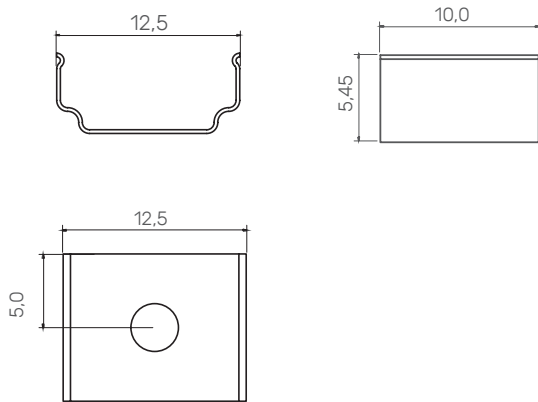

for M3 countersunk screw

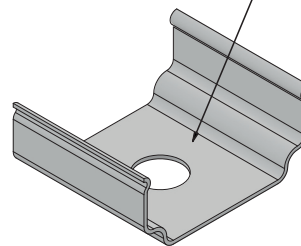

Wire Options

2M

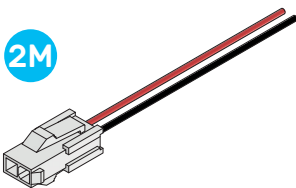

4M

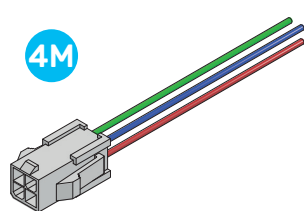

Model	Type	Length "c" (mm)
ELED-CAB-xxx-2M	2M	on request
ELED-CAB-xxx-4M	4M	on request
ELED-CAB-150-1C	1C	1500
ELED-CAB-050-2C	2C	500
ELED-CAB-050-3C	3C	500

*custom length on request

1C

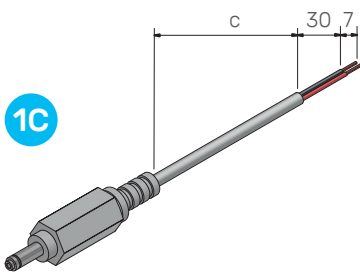

Wire AWG 24

2C

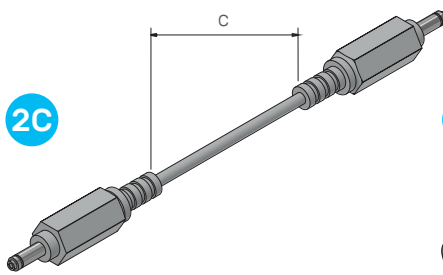

3C

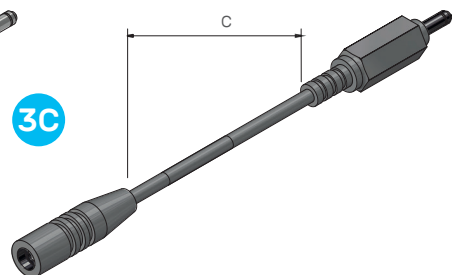

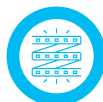

Serie E

LIGHTING SOLUTION

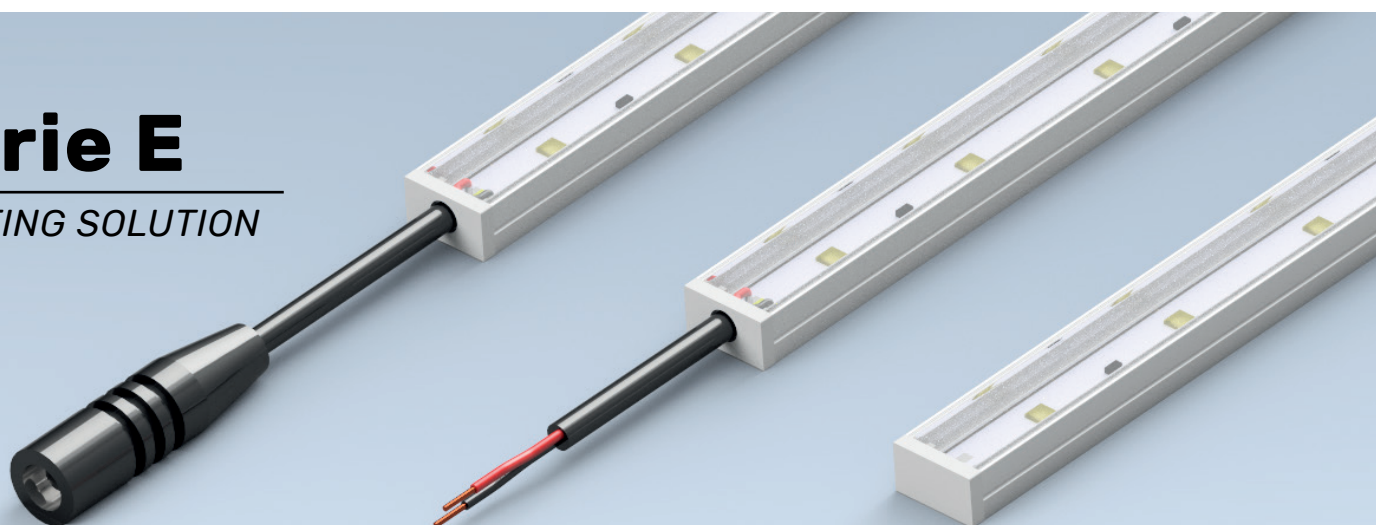

24V
DC

120°

IP55

22.5W/m

Product Features

- CRI 80Ra
- Highest quality components 2835 Leds
- 120° beam angle
- CCT white CCT available from 2800K 3000 ÷ 6500, PINK, RGB, Custom.
- 24V DC input voltage
- Up to 1200 lm/m
- Ambient Temperature: -20°C to 45°C
- Max Power consumption 22.5W/m
- IP Rating: IP55
- Lifetime 50.000h
- Energy labelling available (EPREL)

Customization

- Custom CCT to obtain your cromatic coordinates
- Custom length on request
- CRI 90Ra on request
- Input voltage on request

Material:

Cover in polycarbonate clear or opal
Side closure cap in PA 6
Profile in aluminium

Standard:

EN 62031-1, EN 62471-1, EN 61547-1, EN55015-1,
EN 60598-1, EN 60335-2-24, EN 60335-2-89

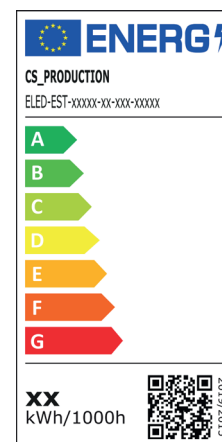

Dimensions

Dimension in mm

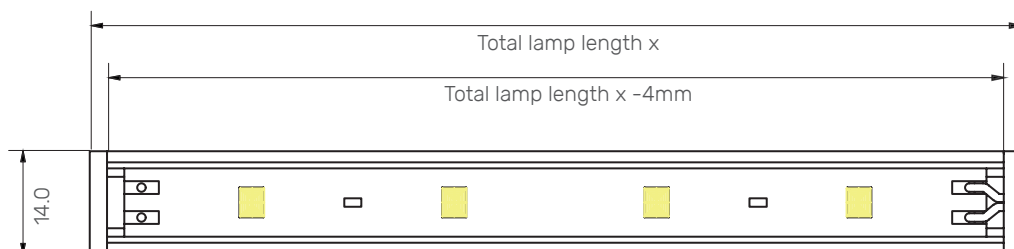



Specifications

COMBINATION CODE			(1)	(2)	(3)	VALUE					
Model	Length	Led Type	Voltage (V)	CCT* (K)	Connection*		Covering Finishing*	Lumen (lm)	Power (W)	n°LED	Length "x" (mm)
					R	L					
ELED-CSE	060	2835	24	3000 ÷ 6500 PINK RGB	B C D	B C D Z	0	432	4,5	36	604
							1	378			
ELED-CSE	090	2835	24	3000 ÷ 6500 PINK RGB	B C D	B C D Z	0	648	6,75	54	904
							1	567			
ELED-CSE	120	2835	24	3000 ÷ 6500 PINK RGB	B C D	B C D Z	0	864	9	72	1204
							1	756			
ELED-CSE	150	2835	24	3000 ÷ 6500 PINK RGB	B C D	B C D Z	0	1080	11,5	90	1504
							1	945			
High Performance Model											
ELED-CHE	060	2835	24	3000 ÷ 6500 PINK RGB	B C D	B C D Z	0	720	9	72	604
							1	630			
ELED-CHE	090	2835	24	3000 ÷ 6500 PINK RGB	B C D	B C D Z	0	1080	13,5	108	904
							1	945			
ELED-CHE	120	2835	24	3000 ÷ 6500 PINK RGB	B C D	B C D Z	0	1440	18	144	1204
							1	1250			
ELED-CHE	150	2835	24	3000 ÷ 6500 PINK RGB	B C D	B C D Z	0	1800	22,5	180	1504
							1	1575			

* choose an option from below

Color Temperature Options (1)



Connection Options (2)

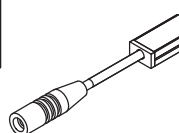
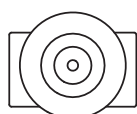

B Wire and 3,5x1,35 female plug
Length 70mm

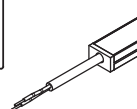

C Connection with wire
Length 70mm

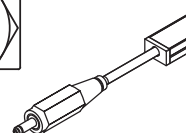

D Wire and 3,5x1,35 male plug
Length 70mm



Z No connection



Cover Finishing (3)

- 0** Clear PC Cover
- 1** Opal PC Cover

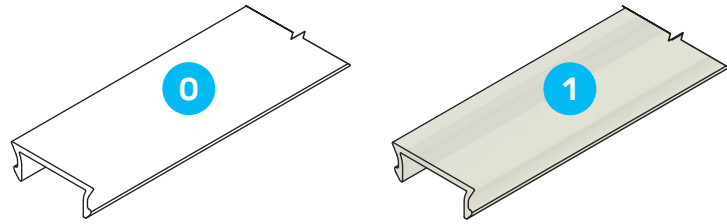

Accessories

Mounting Clip

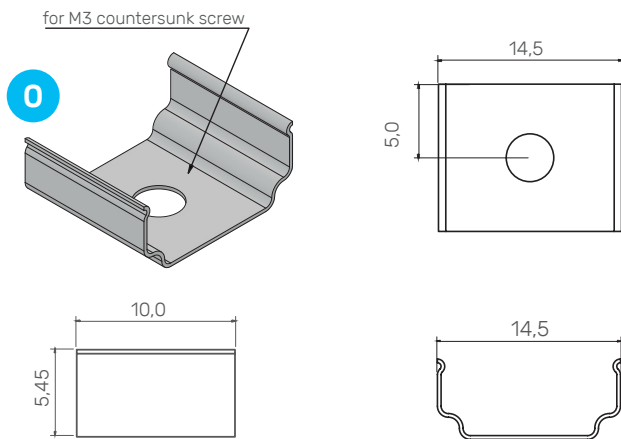

M

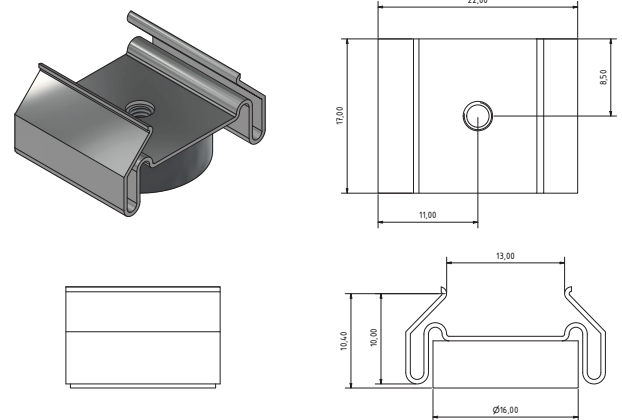

Model	Type
ELED-CSE-CLIP-0	0
ELED-CSE-CLIP-M	M

Wire Options

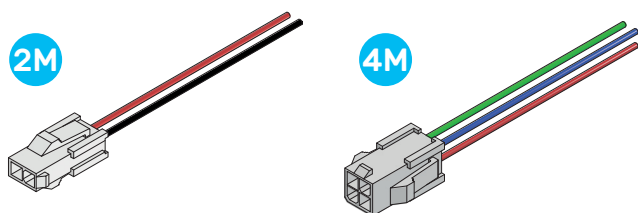

Model	Type	Length "c" (mm)
ELED-CAB-xxx-2M	2M	on request
ELED-CAB-xxx-4M	4M	on request
ELED-CAB-150-1C	1C	1500
ELED-CAB-050-2C	2C	500
ELED-CAB-050-3C	3C	500

*custom length on request

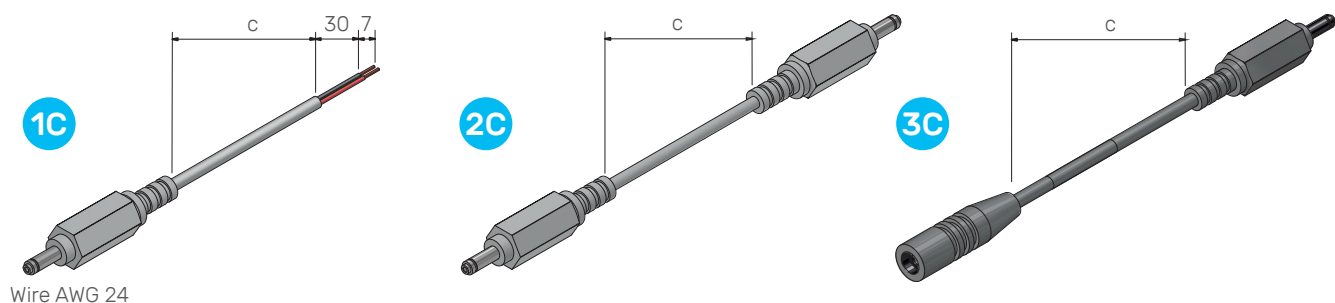

Wire AWG 24



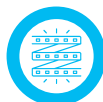

Serie F

LIGHTING SOLUTION

24V
DC

120°

IP65

22.5W/m

Product Features

- CRI 80Ra
- Highest quality components 2835 Leds
- 120° beam angle
- CCT white CCT available from 2800K 3000 ÷ 6500, PINK, RGB, Custom.
- 24V DC input voltage
- Up to 1800 lm/m
- Ambient Temperature: -20°C to 45°C
- Max Power consumption 22.5W/m
- IP Rating: IP65
- Lifetime 50.000h
- Energy labelling available (EPREL)

Customization

- Custom CCT to obtain your cromatic coordinates
- Custom length on request
- CRI 90Ra on request
- Input voltage on request

Material:

Cover in polycarbonate clear or opal
Side closure cap in PA 6
Profile in aluminium

Standard:

EN 62031-1, EN 62471-1, EN 61547-1, EN55015-1,
EN 60598-1, EN 60335-2-24, EN 60335-2-89



Dimensions

Dimension in mm

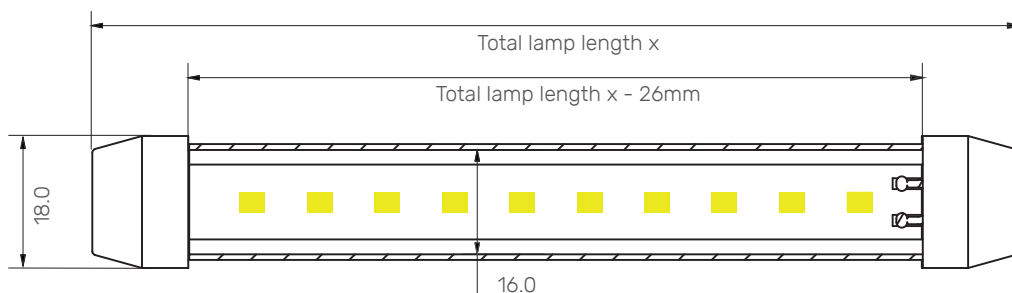

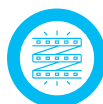

Specifications

COMBINATION CODE			(1)	(2)	(3)	VALUE					
Model	Length	Led Type	Voltage (V)	CCT* (K)	Connection*		Covering Finishing*	Lumen (lm)	Power (W)	n°LED	Length "x" (mm)
ELED-CSF	050	2835	24	3000 ÷ 6500 PINK RGB	B	B	0	411	3,8	54	506
					C	C					
ELED-CSF	098	2835	24	3000 ÷ 6500 PINK RGB	B	B	0	932	7,7	120	986
					C	C					
ELED-CSF	120	2835	24	3000 ÷ 6500 PINK RGB	B	B	0	991	8,9	144	1200
					C	C					
High Performance Model											
ELED-CHF	050	2835	24	3000 ÷ 6500 PINK RGB	B	B	0	900	11,5	90	506
					C	C					
ELED-CHF	098	2835	24	3000 ÷ 6500 PINK RGB	B	B	0	1770	22	177	986
					C	C					
ELED-CHF	120	2835	24	3000 ÷ 6500 PINK RGB	B	B	0	2160	27	216	1200
					C	C					

* choose an option from below

Color Temperature Options (1)



Connection Options (2)

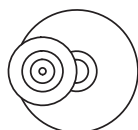

B Wire and 3,5x1,35 female plug
Length 70mm



C Connection with wire
Length 70mm



D Wire and 3,5x1,35 male plug
Length 70mm



Z No connection





Cover Finishing (3)

0 Clear PC Cover

1 Opal PC Cover

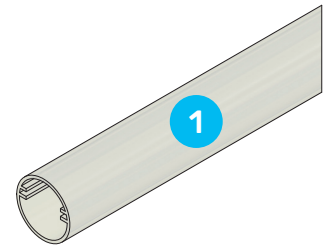
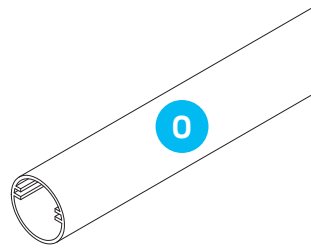

Accessories

Mounting Clip

Model	Type
ELED-CSF-CLIP-0	0

0

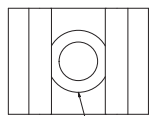
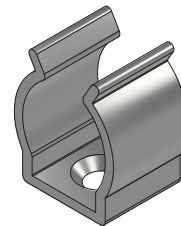
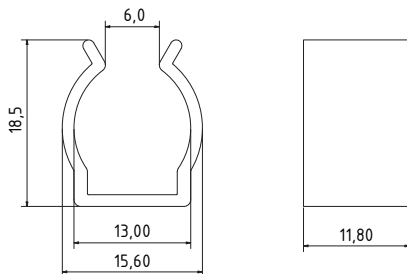

M3 countersunk screw

Wire Options

2M

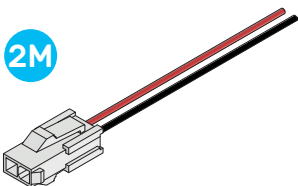

4M

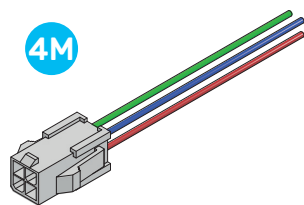

Model	Type	Length "c" (mm)
ELED-CAB-xxx-2M	2M	on request
ELED-CAB-xxx-4M	4M	on request
ELED-CAB-150-1C	1C	1500
ELED-CAB-050-2C	2C	500
ELED-CAB-050-3C	3C	500

*custom length on request

1C

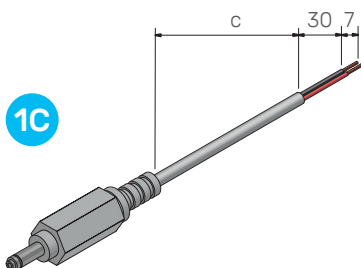

Wire AWG 24

2C

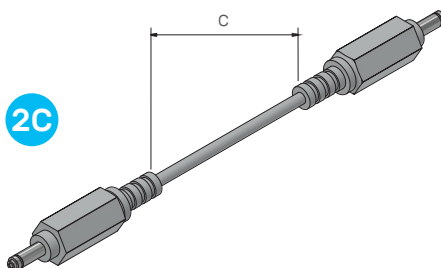

3C

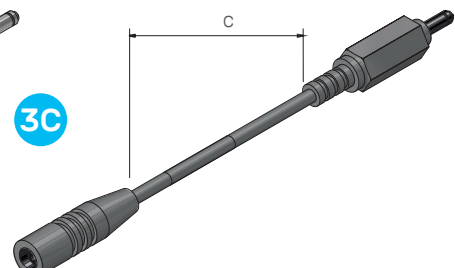

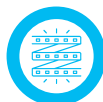

Serie G

LIGHTING SOLUTION

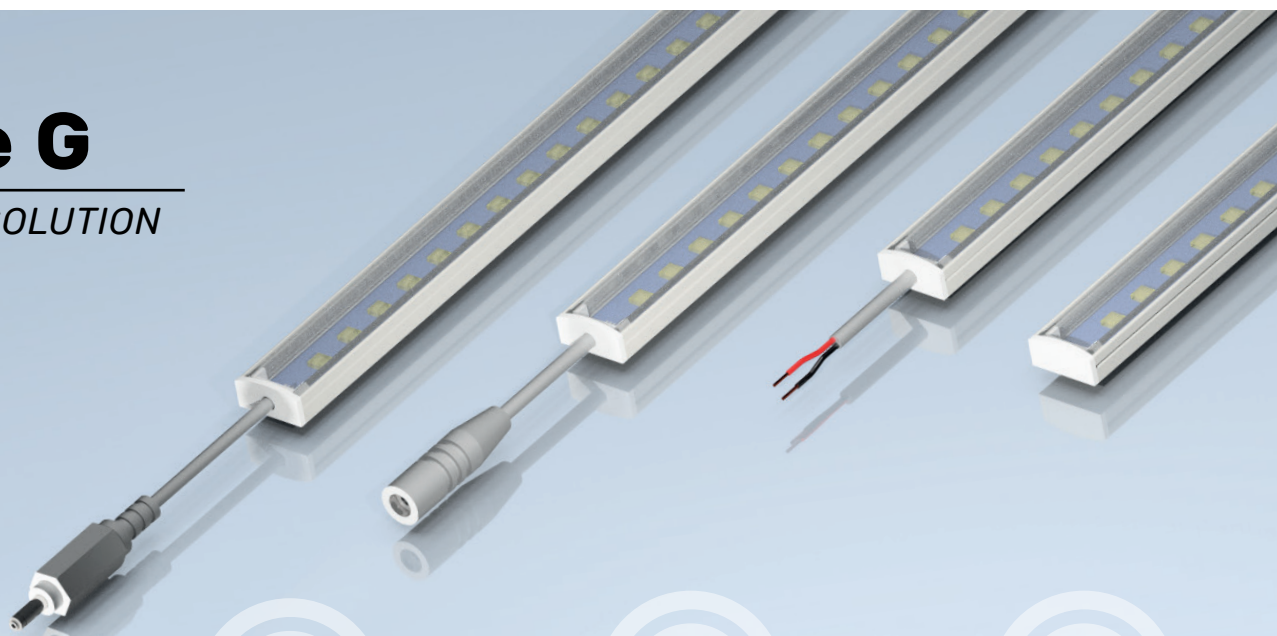

24V
DC

120°

IP65

22.5W/m

Product Features

- CRI 80Ra
- Highest quality components 2835 Leds
- Double 120° beam angle
- CCT white CCT available from 2800K 3000 ÷ 6500, PINK, RGB, Custom.
- 24V DC input voltage
- Up to 1200 lm/m
- Ambient Temperature: -20°C to 45°C
- Max Power consumption 22.5W/m
- IP Rating: IP65
- Lifetime 50.000h
- Energy labelling available (EPREL)

Customization

- Custom CCT to obtain your cromatic coordinates
- Custom length on request
- CRI 90Ra on request
- Input voltage on request

Material:

Cover in polycarbonate clear or opal
Side closure cap in PA 6
Profile in aluminium

Standard:

EN 62031-1, EN 62471-1, EN 61547-1, EN55015-1,
EN 60598-1, EN 60335-2-24, EN 60335-2-89

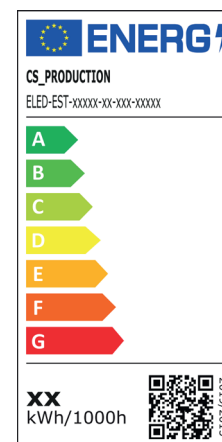

Dimensions

Dimension in mm

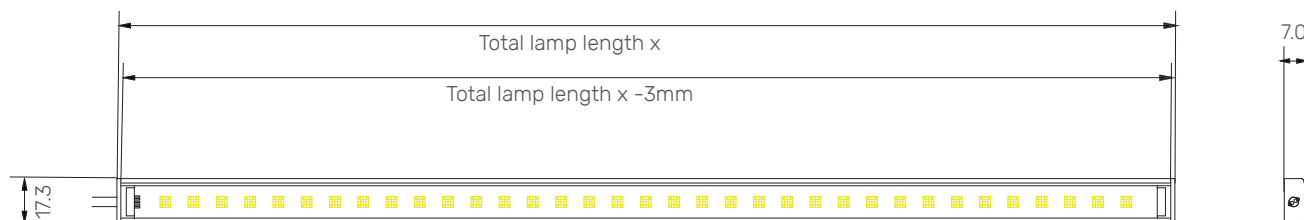

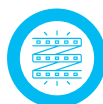

Specifications

COMBINATION CODE		(1)	(2)	(3)	VALUE						
Model	Length	Led Type	Voltage (V)	CCT* (K)	Connection*		Covering Finishing*	Lumen (lm)	Power (W)	n°LED	Length "x" (mm)
ELED-CSG	060	2835	24	3000 ÷ 6500 PINK RGB	B C D	B C D Z	0	432	4,5	36	603
							1	378			
ELED-CSG	090	2835	24	3000 ÷ 6500 PINK RGB	B C D	B C D Z	0	648	6,75	54	903
							1	567			
ELED-CSG	120	2835	24	3000 ÷ 6500 PINK RGB	B C D	B C D Z	0	864	9	72	1203
							1	756			
ELED-CSG	150	2835	24	3000 ÷ 6500 PINK RGB	B C D	B C D Z	0	1080	11,5	90	1503
							1	945			
High Performance Model											
ELED-CHG	060	2835	24	3000 ÷ 6500 PINK RGB	B C D	B C D Z	0	720	9	72	603
							1	630			
ELED-CHG	090	2835	24	3000 ÷ 6500 PINK RGB	B C D	B C D Z	0	1080	13,5	108	903
							1	945			
ELED-CHG	120	2835	24	3000 ÷ 6500 PINK RGB	B C D	B C D Z	0	1440	18	144	1203
							1	1250			
ELED-CHG	150	2835	24	3000 ÷ 6500 PINK RGB	B C D	B C D Z	0	1800	22,5	180	1503
							1	1575			

* choose an option from below

Color Temperature Options (1)



Connection Options (2)

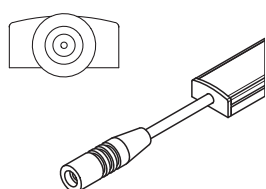

B Wire and 3,5x1,35 female plug
Length 70mm

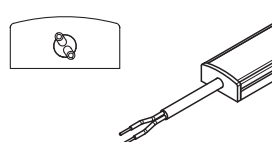

C Connection with wire
Length 70mm

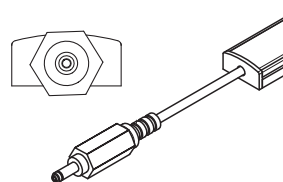

D Wire and 3,5x1,35 male plug
Length 70mm

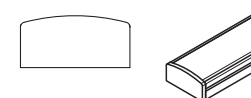

Z No connection



Cover Finishing (3)

- 0 Clear PC Cover
- 1 Opal PC Cover

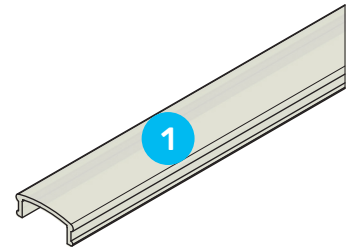
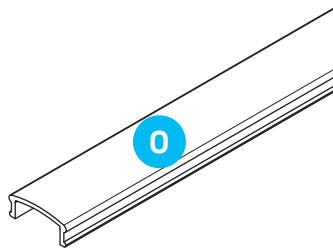

Accessories

Mounting Clip

0

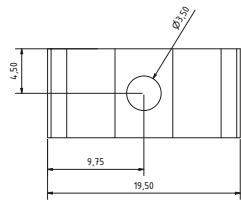
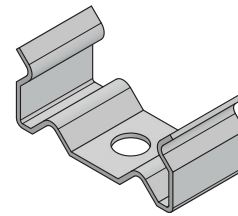
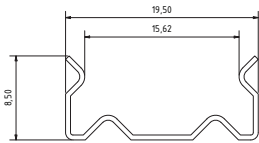

Model	Type
ELED-CSG-CLIP-0	0

Wire Options

2M

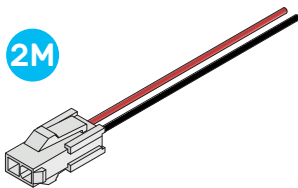

4M

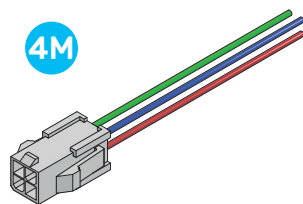

Model	Type	Length "c" (mm)
ELED-CAB-xxx-2M	2M	on request
ELED-CAB-xxx-4M	4M	on request
ELED-CAB-150-1C	1C	1500
ELED-CAB-050-2C	2C	500
ELED-CAB-050-3C	3C	500

*custom length on request

1C

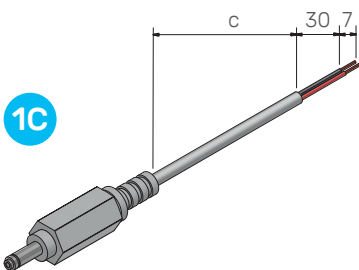

2C

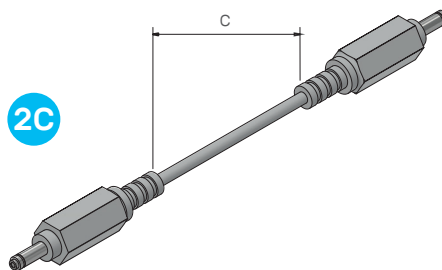

3C

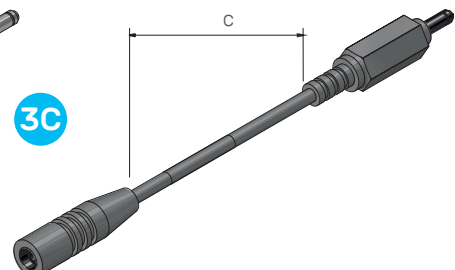

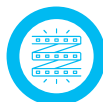

Serie H

LIGHTING SOLUTION

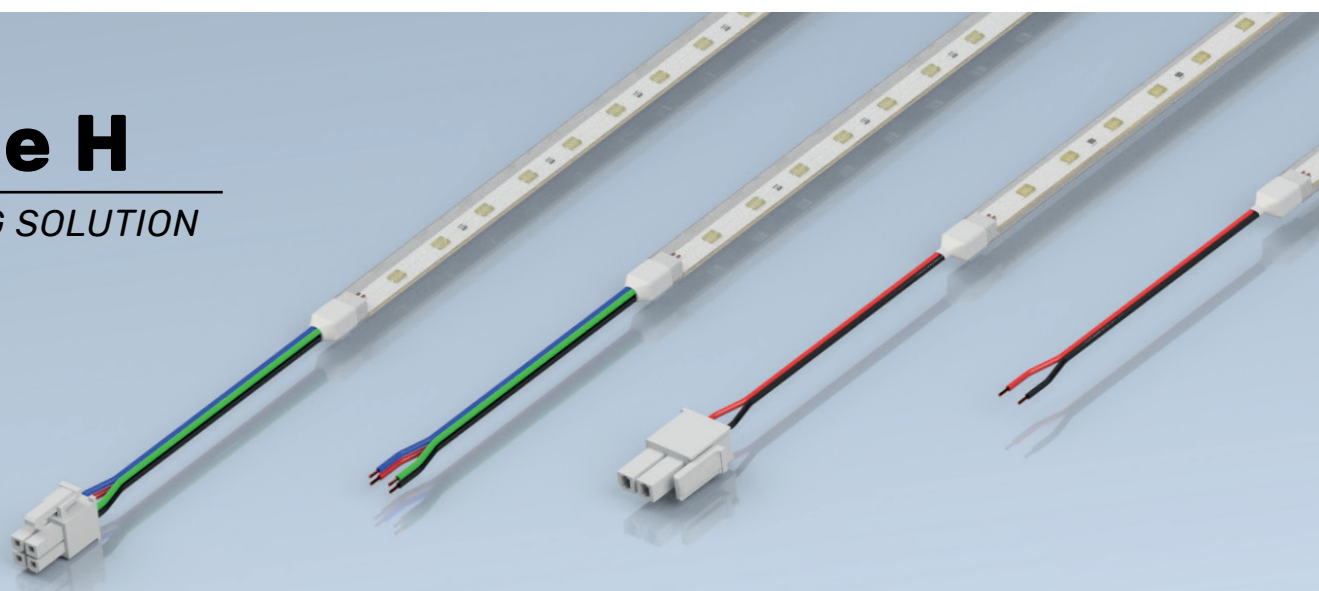

24V
DC

120°

IP65

22.5W/m

Product Features

- CRI 80Ra
- Highest quality components 2835 Leds
- 120° beam angle
- CCT white CCT available from 2800K 3000 ÷ 6500, PINK, RGB, Custom.
- 24V DC input voltage
- Up to 1200 lm/m
- Ambient Temperature: -20°C to 45°C
- Max Power consumption 22.5W/m
- IP Rating: IP65
- Lifetime 50.000h
- Energy labelling available (EPREL)

Customization

- Custom CCT to obtain your cromatic coordinates
- Custom length on request
- CRI 90Ra on request
- Input voltage on request

Material:

Cover in polycarbonate clear or opal
Side closure cap in PA 6
Profile in aluminium

Standard:

EN 62031-1, EN 62471-1, EN 61547-1, EN55015-1,
EN 60598-1, EN 60335-2-24, EN 60335-2-89

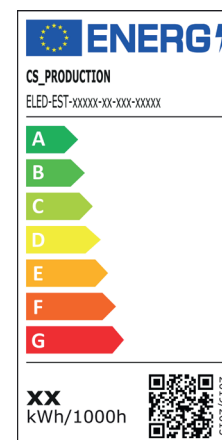

Dimensions

Dimension in mm

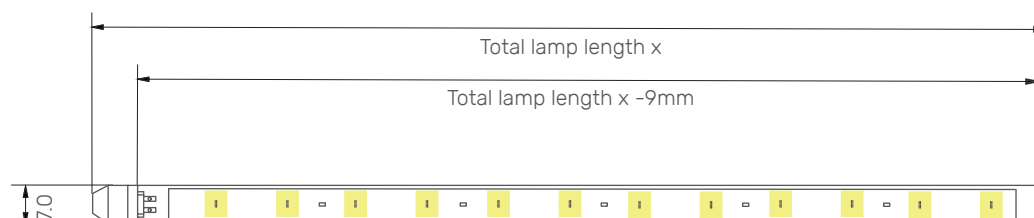



Specifications

COMBINATION CODE			(1)	(2)	(3)	VALUE					
Model	Length	Led Type	Voltage (V)	CCT* (K)	Connection*		Covering Finishing*	Lumen (lm)	Power (W)	n°LED	Length "x" (mm)
ELED-CSH	011	2835	24	3000 ÷ 6500 PINK RGB	C	C Z	0	52	0,5	6	110
							1	45			
ELED-CSH	025	2835	24	3000 ÷ 6500 PINK RGB	C	C Z	0	160	2	18	255
							1	140			
ELED-CSH	035	2835	24	3000 ÷ 6500 PINK RGB	C	C Z	0	210	2,4	24	355
							1	184			
ELED-CSH	076	2835	24	3000 ÷ 6500 PINK RGB	C	C Z	0	390	4	45	760
							1	340			
High Performance Model											
ELED-CHH	011	2835	24	3000 ÷ 6500 PINK RGB	C	C Z	0	108	1,2	12	110
							1	95			
ELED-CHH	025	2835	24	3000 ÷ 6500 PINK RGB	C	C Z	0	270	3	30	255
							1	235			
ELED-CHH	035	2835	24	3000 ÷ 6500 PINK RGB	C	C Z	0	378	4,2	42	355
							1	330			
ELED-CHH	076	2835	24	3000 ÷ 6500 PINK RGB	C	C Z	0	819	9	91	760
							1	715			

* choose an option from below

Color Temperature Options (1)



Connection Options (2)

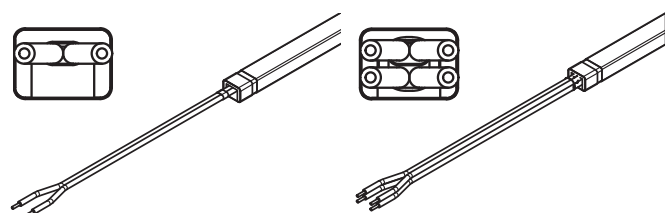

C Connection with wire
Length 70mm

Z No connection

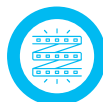

Cover Finishing (3)

0 Clear PC Cover

1 Opal PC Cover

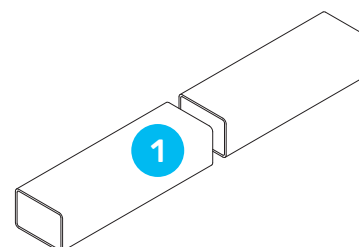
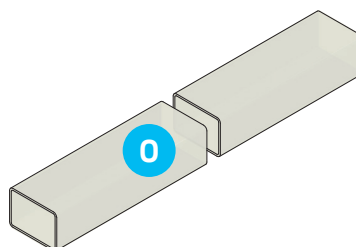

Accessories

Mounting Clip

0

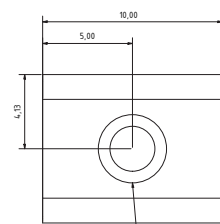
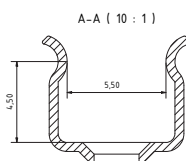
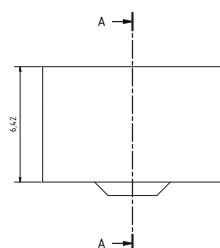

Model	Type
ELED-CSH-CLIP-0	0

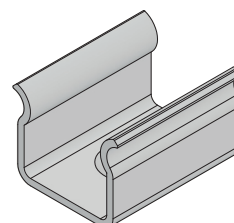

Wire Options

Model	Type	Length "c" (mm)
ELED-CAB-xxx-2M	2M	on request
ELED-CAB-xxx-4M	4M	on request

*custom length on request

2M

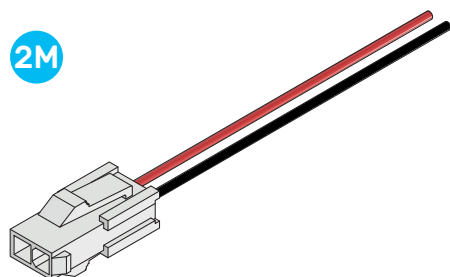

4M

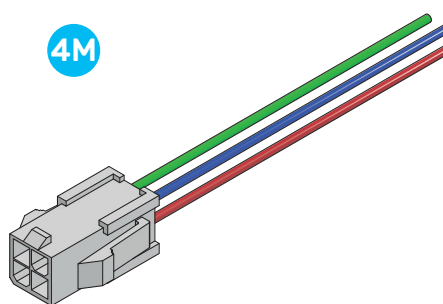

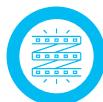

Serie I

LIGHTING SOLUTION

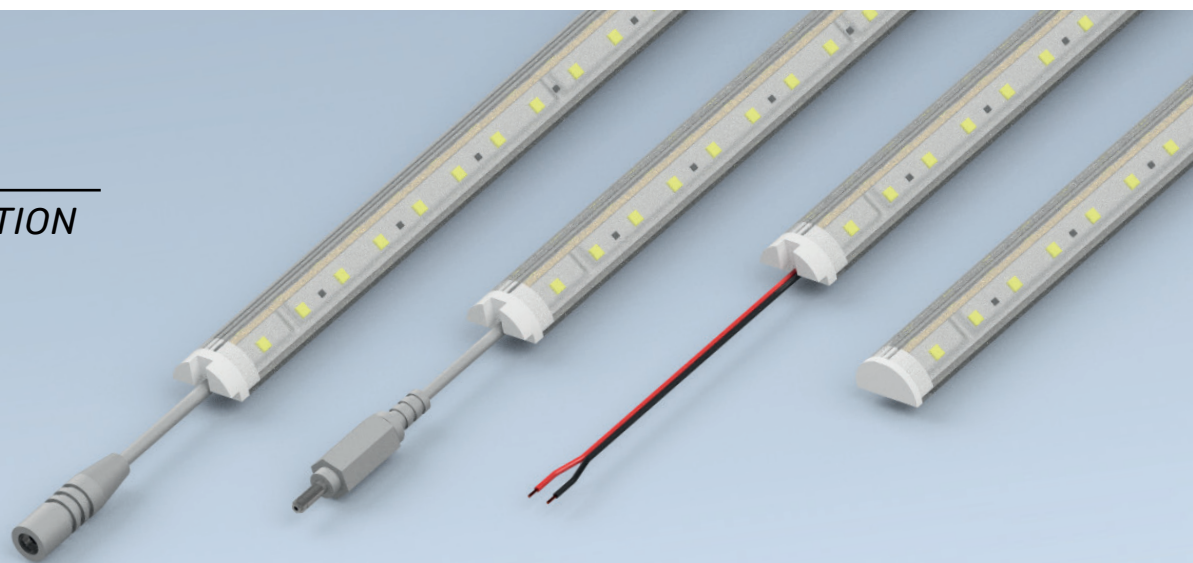

24V
DC

120°
120°

IP65

22.5W/m

Product Features

- CRI 80Ra
- Highest quality components 2835 Leds
- Double 120° beam angle
- CCT white CCT available from 2800K 3000 ÷ 6500, PINK, RGB, Custom.
- 24V DC input voltage
- Up to 1200 lm/m
- Ambient Temperature: -20°C to 45°C
- Max Power consumption 22.5W/m
- IP Rating: IP65
- Lifetime 50.000h
- Energy labelling available (EPREL)

Customization

- Custom CCT to obtain your cromatic coordinates
- Custom length on request
- CRI 90Ra on request
- Input voltage on request

Material:

Cover in polycarbonate clear or opal
Side closure cap in PA 6
Profile in aluminium

Standard:

EN 62031-1, EN 62471-1, EN 61547-1, EN55015-1,
EN 60598-1, EN 60335-2-24, EN 60335-2-89

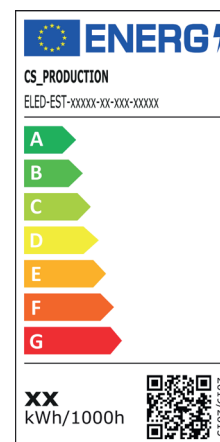

Dimensions

Dimension in mm

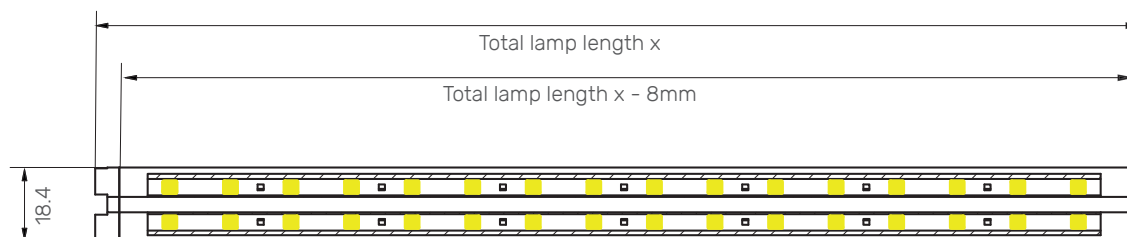



Specifications

COMBINATION CODE			(1)	(2)	(3)	VALUE					
Model	Length	Led Type	Voltage (V)	CCT* (K)	Connection*		Covering Finishing*	Lumen (lm)	Power (W)	n°LED	Length "x" (mm)
ELED-CSI	038	2835	24	3000 ÷ 6500 PINK RGB	B	B	0	390	4	42	380
					C	C	1	335			
ELED-CSI	074	2835	24	3000 ÷ 6500 PINK RGB	B	B	0	970	8,4	168	740
					C	C	1	840			
ELED-CSI	114	2835	24	3000 ÷ 6500 PINK RGB	B	B	0	1170	12	126	1140
					C	C	1	1020			
High Performance Model											
ELED-CHI	038	2835	24	3000 ÷ 6500 PINK RGB	B	B	0	810	9	90	380
					C	C	1	708			
ELED-CHI	074	2835	24	3000 ÷ 6500 PINK RGB	B	B	0	1600	17,8	178	740
					C	C	1	1400			
ELED-CHI	114	2835	24	3000 ÷ 6500 PINK RGB	B	B	0	2430	27	270	1140
					C	C	1	2120			

* choose an option from below

Color Temperature Options (1)



Connection Options (2)

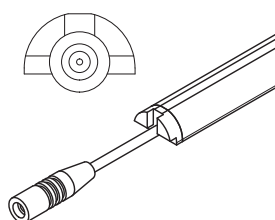

B Wire and 3,5x1,35 female plug
Length 70mm

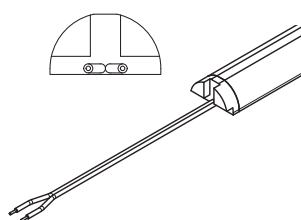

C Connection with wire
Length 70mm

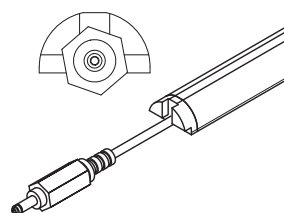

D Wire and 3,5x1,35 male plug
Length 70mm

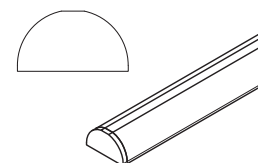

Z No connection



Cover Finishing (3)

- 0 Clear PC Cover
- 1 Opal PC Cover

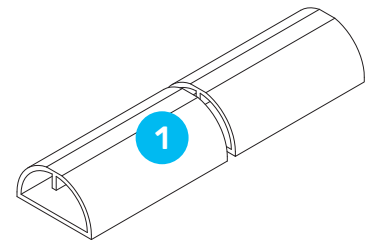
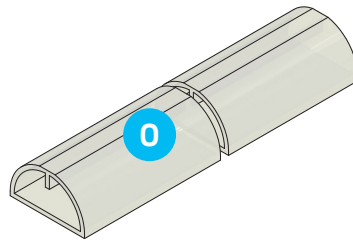

Accessories

Mounting Clip

0

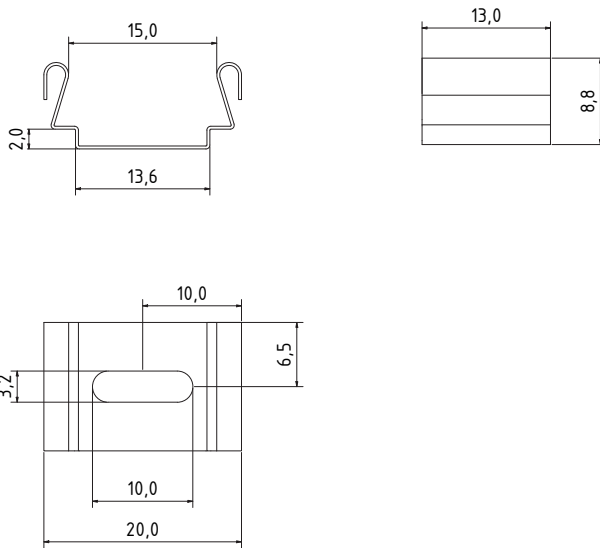

Model	Type
ELED-CSI-CLIP-0	0

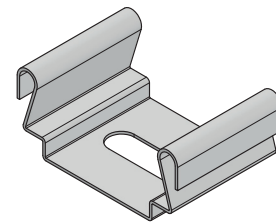

Wire Options

2M

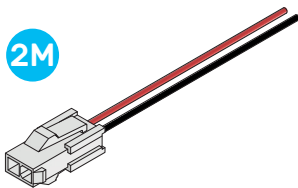

4M

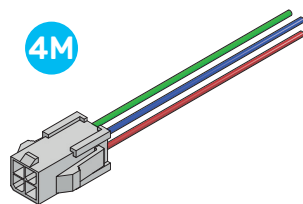

Model	Type	Lenght "c" (mm)
ELED-CAB-xxx-2M	2M	on request
ELED-CAB-xxx-4M	4M	on request
ELED-CAB-150-1C	1C	1500
ELED-CAB-050-2C	2C	500
ELED-CAB-050-3C	3C	500

*custom length on request

1C

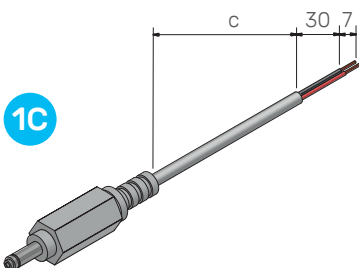

2C

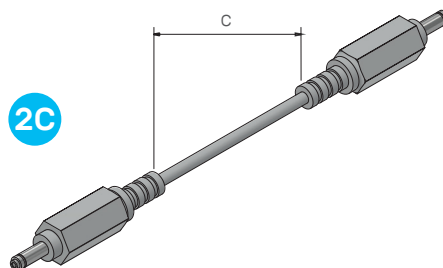

3C

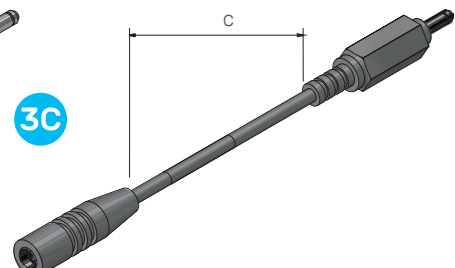



Optical Characteristics

2835 Single LED package

Relative Spectral Distribution

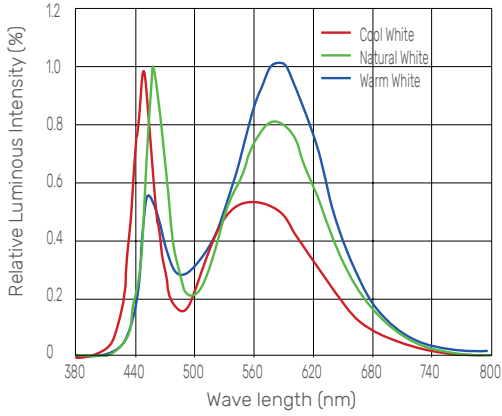

Typical Spectral Distribution

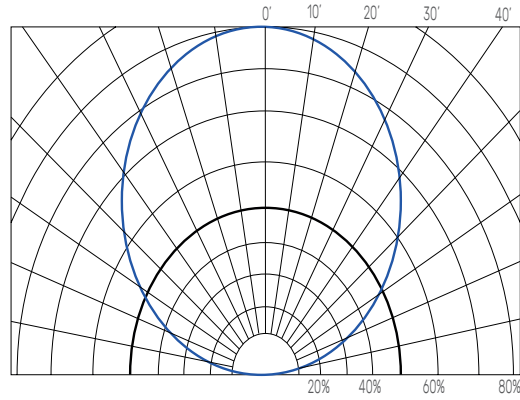

White Spectrum test Report

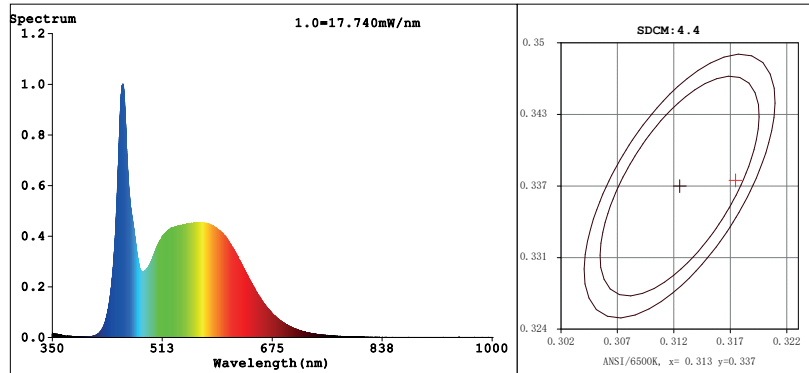

RGB Spectrum test Report

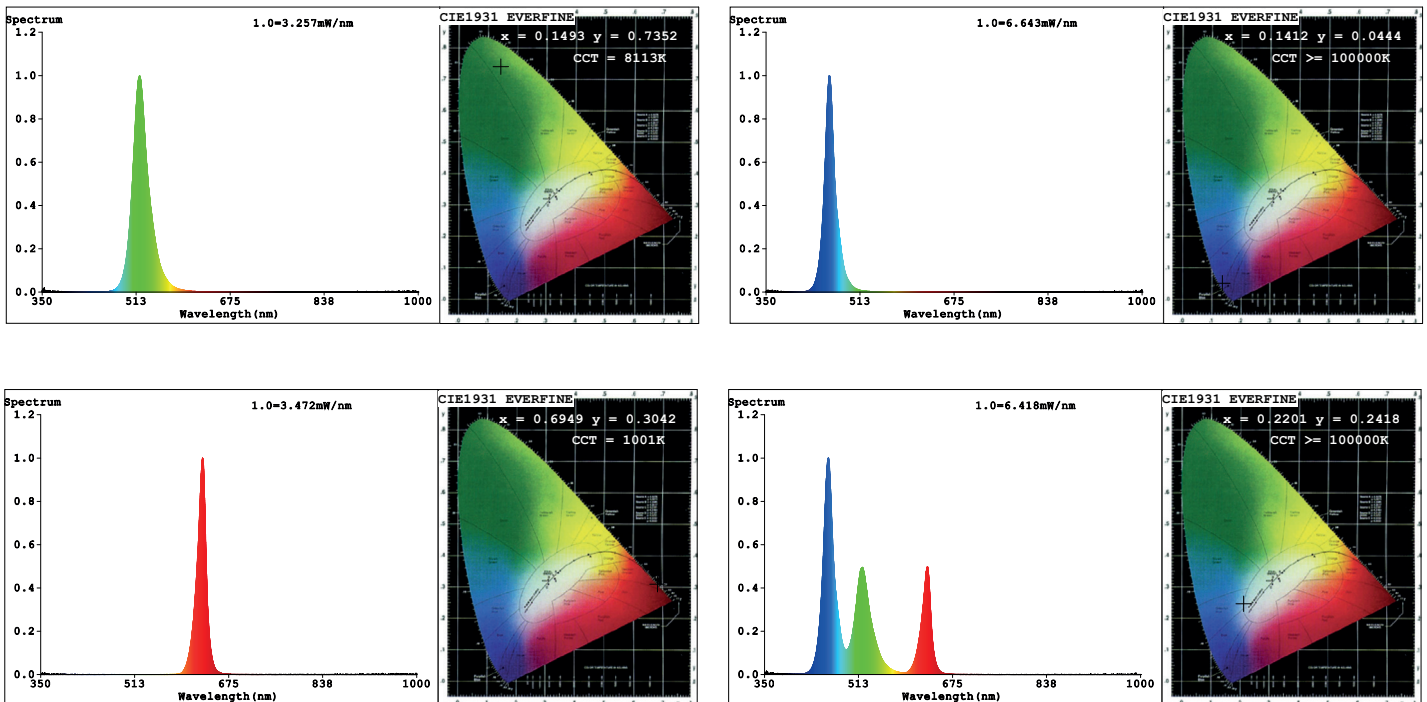



CODIFICATION

LIGHTING SOLUTION

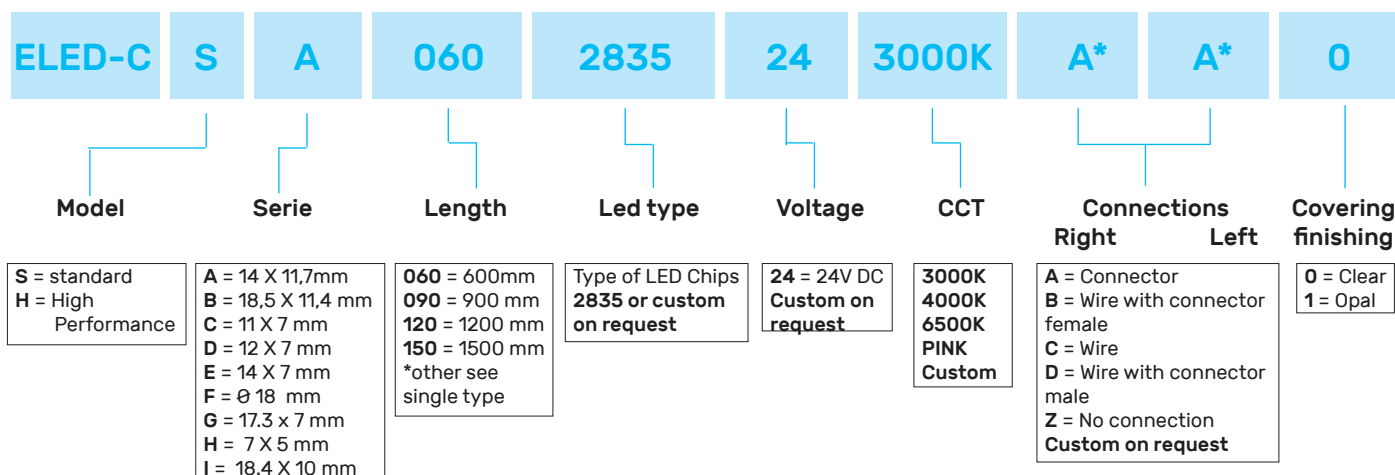



Gruppo Comestero Sistemi



People Making Business

HEADQUARTER

Comestero Sistemi S.r.l.
Via Bolzano, 1/E
20871 Vimercate (MB) Italy
Tel +39.039625091
Fax +39.039667479
info@comestero.com

comestero.com

BRANCH OFFICE

Comestero Sistemi S.r.l.
Via Valsugana, 88
36022 Cassola (VI) Italy
Tel +39.04241700126
Fax +39.04241700129
info@comestero.com

comestero.com



Tel +39.0396250932
info@comestero.shop

comestero.shop



Phi Drive S.r.l.
Via Roberto Ruffilli 8/10
20042 Pessano Con Bornago (MI) Italy
Tel +39.0396250971
sales@phidrive.eu

phidrive.eu



Penta Group S.r.l.
Via Ciucani 17
20876 Ornago (MB) Italy
Tel +39.0396612820
Fax +39 039.6880435
info@pentagroupsrl.it

pentagroupsrl.it



NSF Controls Ltd
Ingrow Bridge Works, Keighley,
West Yorkshire, BD21 5EF England
Tel: +44(0)1535661144
Fax: +44(0)1535661474
info@nsfcontrols.co.uk

nsfcontrols.co.uk